

Caliper adapter mounting instructions

Thank you for purchasing this Moto-Master performance product. Please read these instructions carefully before attempting installation. *

Step 1

Remove adapter bolts (1).
Remove cable tie (2) and disconnect plug-in connector (3). (if required)
Pull off caliper-adapter combination (4+5).
Remove R-clip (6), brake pad pin (7) and brake pads (8).
Pull off caliper (4) from the adapter (5).

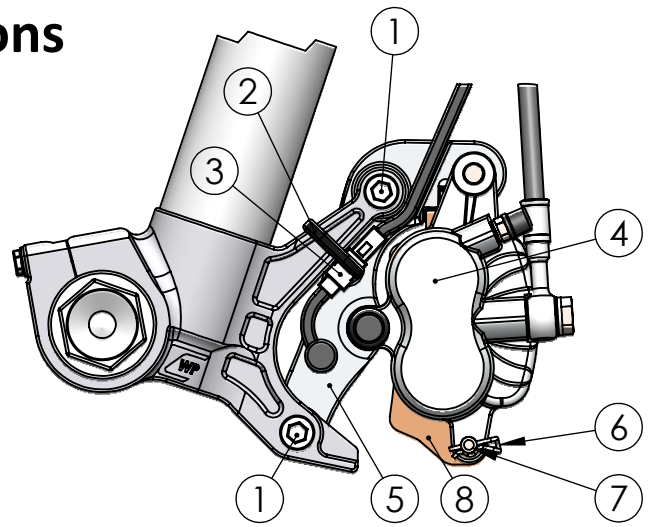

Step 2

Remove collar (9), retaining plate (10) and sliding pin (11) from original adapter (5).
Mount collar (9) and retaining plate (10) on Moto-Master adapter (12).
Mount sliding pin (11) on Moto-Master adapter (12) and tighten to 25 Nm with Loctite 243.
Remove speed sensor cable from original adapter (5) and mount on Moto-Master adapter (12). (if required)

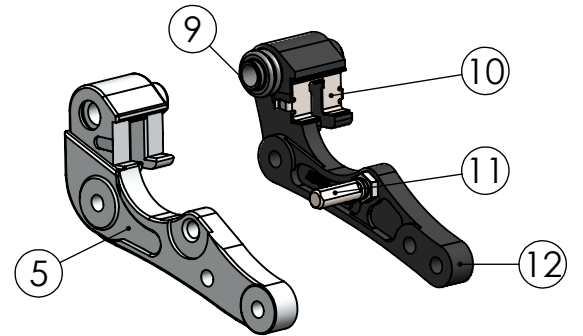

Step 3

Mount new (oversize) brake disc according to mounting instructions. (if required)

Mount caliper (4) on to Moto-Master adapter (12).
Install brake pads (8), brake pad pin (7) and R-clip (6).
Clean adapter mount contact areas.
Position caliper-adapter combination (4+12),
mount adapter bolts (1) and tighten to 25 Nm with Loctite 243.
Use original bolts when no extra bolts are supplied in Moto-Master package.
Connect plug-in connector (3) and mount cable tie (2). (if required)

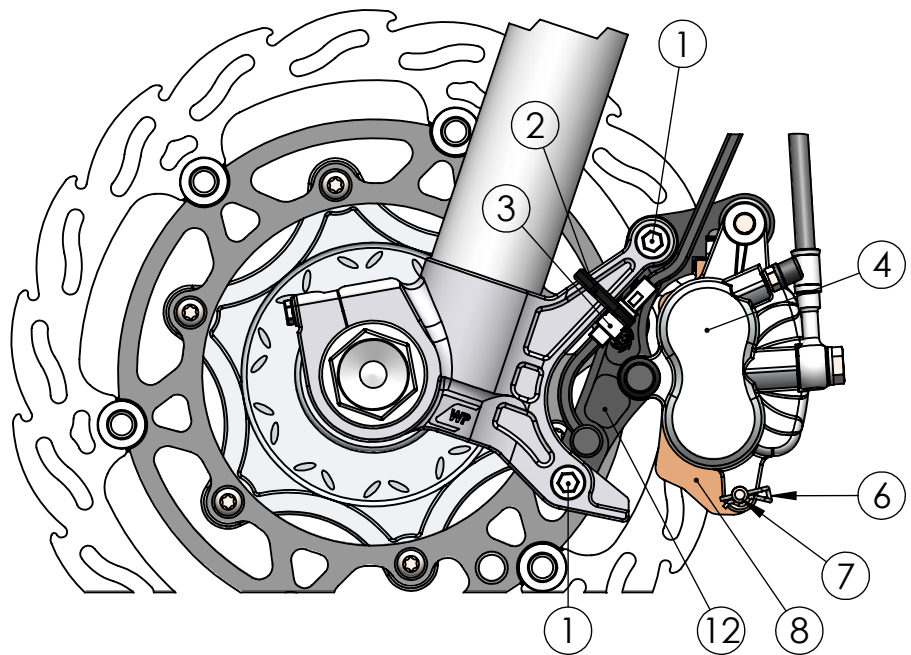

Step 4

Check for proper brake disc to caliper alignment. The brake disc should be positioned in the center of the caliper. (From top view)
Lift front wheel and operate front brake repeatedly. Check for proper engagement and release of front brake. After releasing the brake the wheel should spin free of drag.

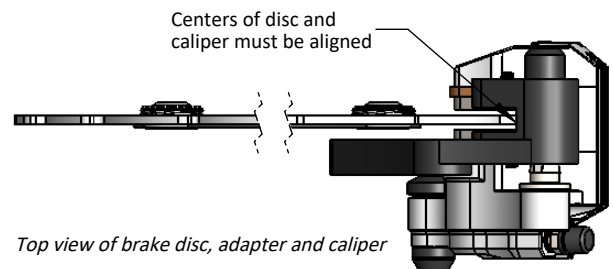

*Consult a certified dealer or professional mechanic if you are not fully qualified in motorcycle maintenance. Moto-Master cannot be held responsible for any damage or injury caused by incorrect product mounting, disregarding specifications and these instructions, or product mounting by an unqualified third party.



For more info, check:

WWW.MOTO-MASTER.COM